

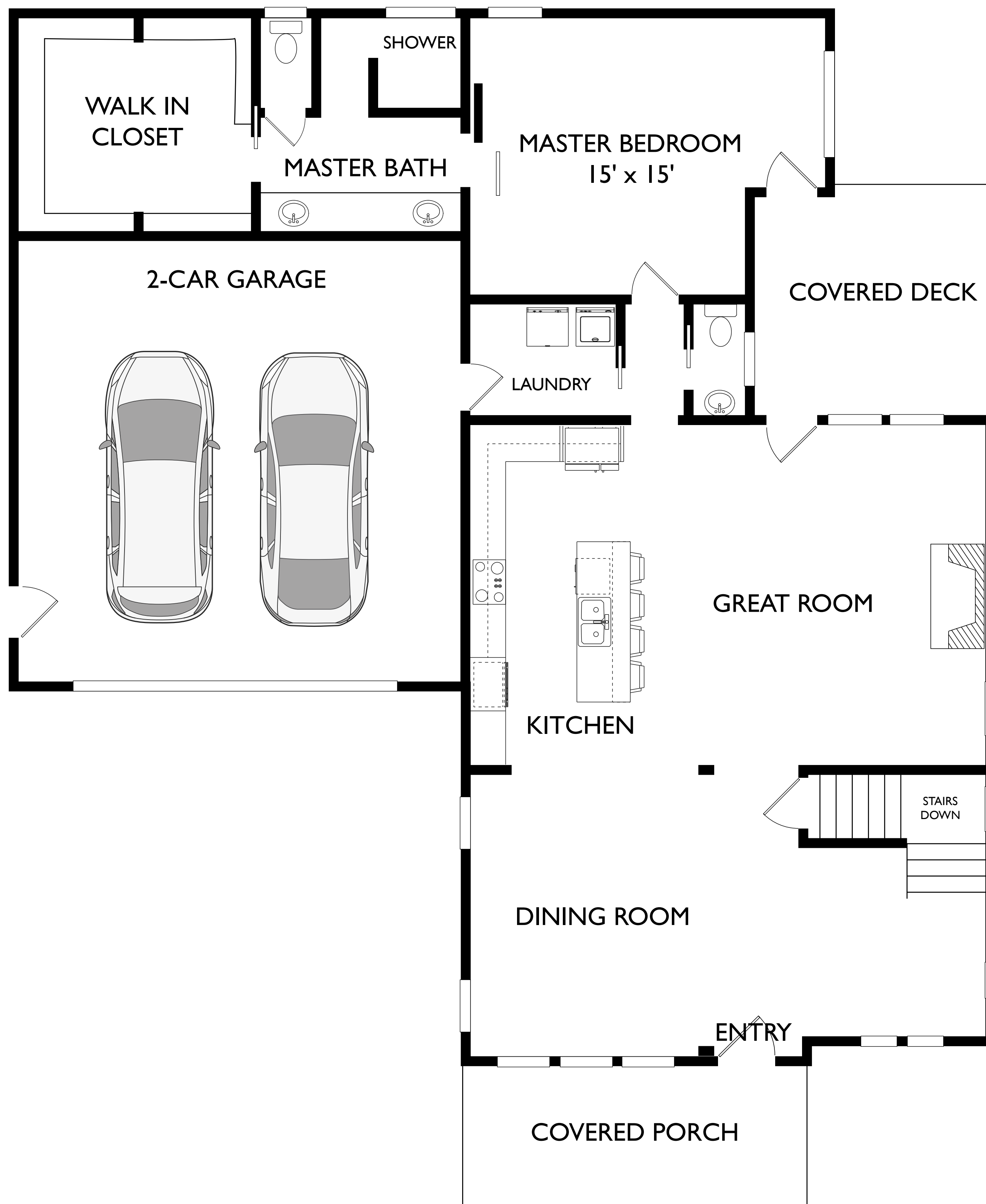

The St. James

1,733 SQUARE FEET • 3 BEDROOMS • 3 BATHS

The St James (Homearama 2018) features 4000 square feet of classic craftsmanship with an old fashion front porch and a magnificent open floor plan. When opening the front door you don't know where to look first ...you enter into a spacious foyer with a spectacular open staircase, a lovely dining room with two walls of windows, a gourmet kitchen with large island and custom cabinets, and a magnificent great room with a fireplace and hearth. Off the great room is a spacious covered porch perfect for outdoor entertaining. Additional features are a master wing with sitting area and walk-in closet plus access to the covered porch. The upper level offers a children's retreat, three bedrooms and full bath, Perfect for entertaining is the lower level with a guest suite, theater room, and great storage.



Floor plan is for illustration only. Designs and specifications may be revised.